

GAUGE BLOCK HOLDER/HANDLE

EACH UNIT INCLUDES: ALUMINUM HOLDER WITH BLACK OXIDE COATED STEEL CLAMP HOLDER WITH SPLIT RING AND BRASS LABEL TAG (SHOWN WITH GAUGE BLOCK (NOT INCLUDED) GAUGE BLOCKS CAN BE ORDERED ALSO BY REQUEST (ADDITIONAL FEE))

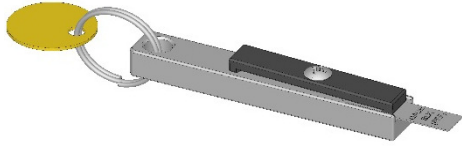

#MJF-95878-1(SINGLE) \$36.00*

0.020" – 0.250" GAUGE BLOCK HOLDING RANGE

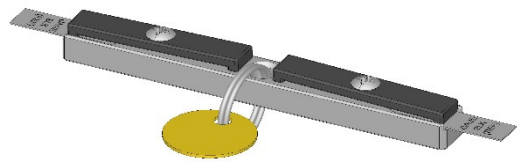

#MJF-95878-1B(DOUBLE) \$42.00*

#MJF-95878-2(SINGLE) \$36.00*

0.200" – 0.400" GAUGE BLOCK HOLDING RANGE

#MJF-95878-2B(DOUBLE) \$42.00*

#MJF-95878-3(SINGLE) \$39.00*

0.350" – 0.550" GAUGE BLOCK HOLDING RANGE

#MJF-95878-3B(DOUBLE) \$45.00*

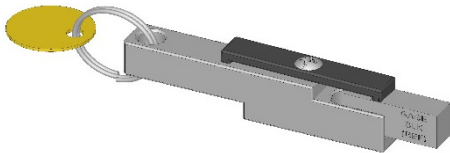

#MJF-95878-4(SINGLE) \$45.00*

0.500" – 0.700" GAUGE BLOCK HOLDING RANGE

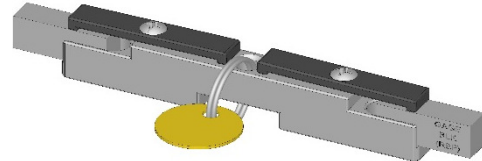

#MJF-95878-4B(DOUBLE) \$51.00*

#MJF-95878-5(SINGLE) \$48.00*

0.650" – 0.850" GAUGE BLOCK HOLDER RANGE

#MJF-95878-5B(DOUBLE) \$63.00*

#MJF-95878-6(SINGLE) \$51.00*

0.800" – 1.000" GAUGE BLOCK HOLDER RANGE

#MJF-95878-6B(DOUBLE) \$66.00*

THIS HOLDER/HANDLE ALLOWS THE CUSTOMER TO MOUNT GAUGE BLOCKS IN A CONVENIENT HANDLE TO FACILITATE EASE OF USE DURING BASIC PART OR EQUIPMENT INSPECTION. THE BRASS TAG GIVES THE CUSTOMER A PLACE TO ENGRAVE OR LABEL A PART NUMBER, DETAIL, ETC BUT ALSO GIVES A LOCATION TO INSTALL CERTIFICATION STICKER. (PRESENT SHIPPING 2-3 BUSINESS DAYS FROM ORDER)

***SHIPPING NOT INCLUDED IN COST OF UNIT**

ALL MAJOR CREDIT CARDS ACCEPTED



4700 BARDEN COURT SE, KENTWOOD, MI 49512; PH: 616-698-3124; FAX: 616-698-2364